

Syracuse University

**SURFACE**

---

Architecture Senior Theses

School of Architecture Dissertations and  
Theses

---

5-2015

## Stimulating the Urban Domain in High-Rise Social Housing Developments

Heather Dela Cruz

Follow this and additional works at: [https://surface.syr.edu/architecture\\_theses](https://surface.syr.edu/architecture_theses)



Part of the [Architecture Commons](#)

---

### Recommended Citation

Dela Cruz, Heather, "Stimulating the Urban Domain in High-Rise Social Housing Developments" (2015).  
*Architecture Senior Theses*. 281.

[https://surface.syr.edu/architecture\\_theses/281](https://surface.syr.edu/architecture_theses/281)

This Thesis is brought to you for free and open access by the School of Architecture Dissertations and Theses at SURFACE. It has been accepted for inclusion in Architecture Senior Theses by an authorized administrator of SURFACE. For more information, please contact [surface@syr.edu](mailto:surface@syr.edu).

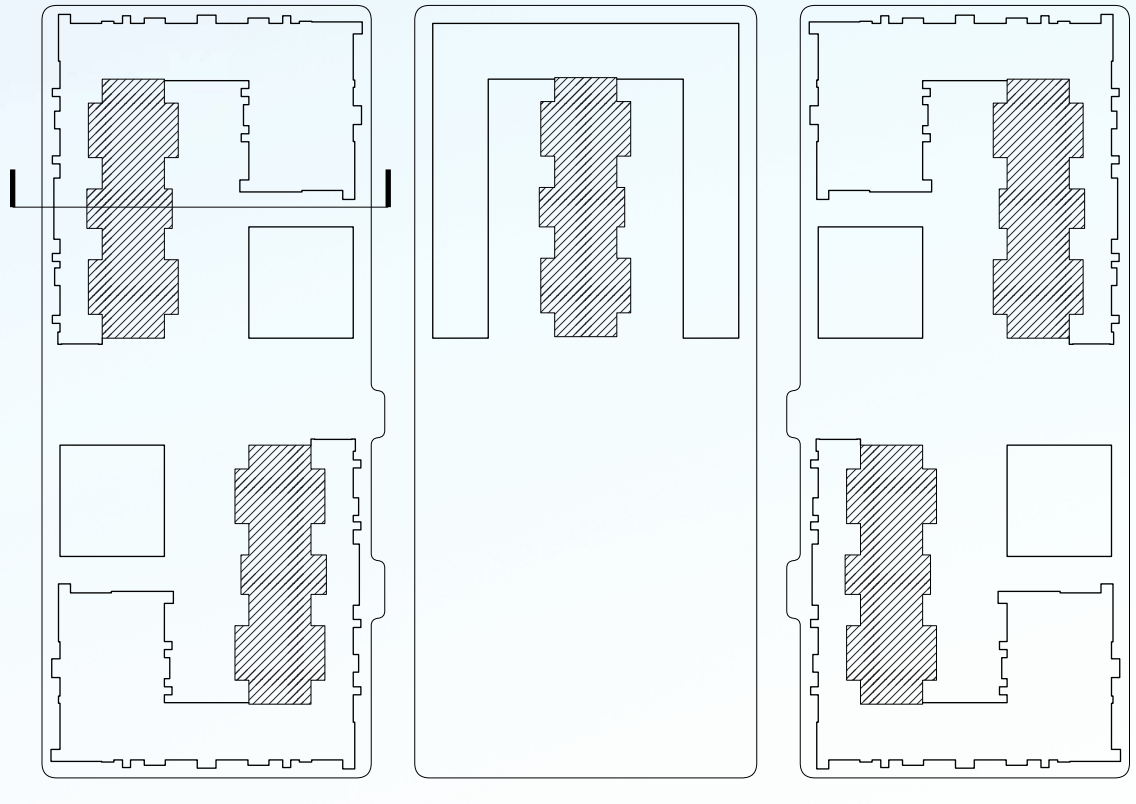

EAST-WEST SECTION THROUGH TOWER COMMUNITY SPACES

